

C:\Users\Stalder\OneDrive\Desktop\Revit Local Files\BWHI - Hospitality Improvements-CENTRAL_ewilson@indarchitecture.com.rvt

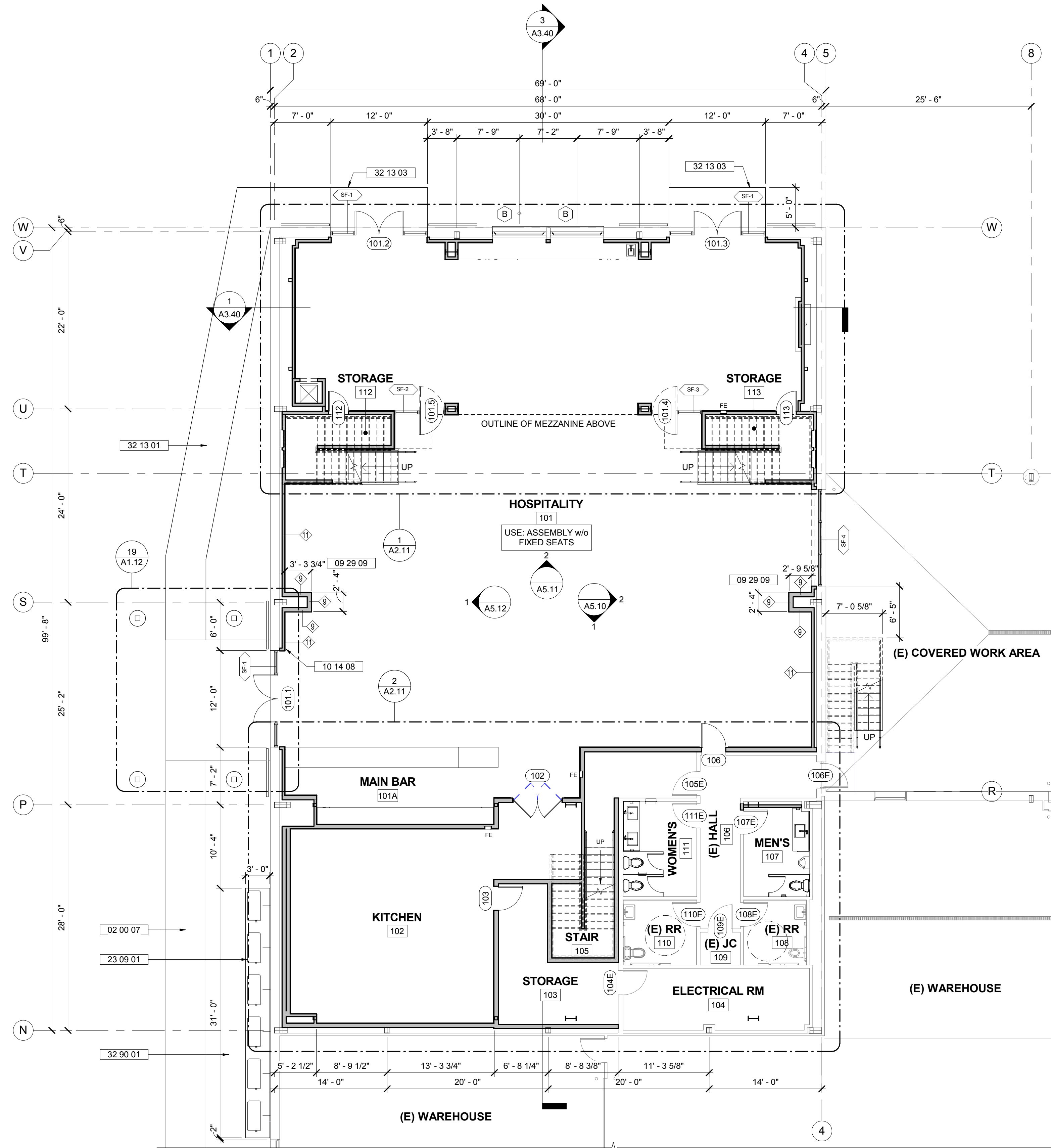

1 FIRST LEVEL FLOOR PLAN - NEW HOSPITALITY AREA
1/8" = 1'-0"

GENERAL SHEET NOTES

- THE EXISTING BUILDING INFORMATION SHOWN HEREIN IS BASED UPON DRAWINGS PREPARED BY O'MALLEY WILSON WESTPHAL - A/E ALLIANCE DATED JANUARY 27, 2014, REVISED MAY 12, 2014.
- PROVIDE MINIMUM 2A-10B-C FIRE EXTINGUISHERS IN LOCATIONS INDICATED ON PLAN. CONTRACTOR TO VERIFY EXACT LOCATION IN THE FIELD WITH FIRE DEPARTMENT HAVING JURISDICTION AFTER WALLS HAVE BEEN FRAMED BUT PRIOR TO CLOSE-IN. THE TOP OF THE EXTINGUISHERS SHALL BE MOUNTED BETWEEN 3'-6" TO 5'-0" A.F.F.
- PROVIDE STRIPING AND HANDRAIL EXTENSIONS AT ALL STAIRS IN COMPLIANCE WITH DETAIL 2/A3.40.

SHEET KEYNOTES

| | |
|----------|--|
| 02 00 07 | EXISTING CONCRETE SIDEWALK TO REMAIN |
| 09 29 09 | CENTER COLUMN ENCLOSURE ON (E) STEEL FRAMING U.N.O. AND PROVIDE SUFFICIENT DEPTH TO INSURE WALLS ARE PLUMB FOR THEIR ENTIRE HEIGHT |
| 10 14 08 | PROVIDE NEW SIGNAGE ON WALL ADJACENT TO DOOR 101.1 STATING "MAXIMUM NUMBER OF OCCUPANTS ON FIRST LEVEL = 259". VERIFY FINAL LOCATION IN FIELD WITH AHJ PRIOR TO INSTALLATION |
| 23 09 01 | NEW PAD-MOUNTED HVAC CONDENSERS, S.M.D. |
| 32 13 01 | NEW CONCRETE SIDEWALK WITH MAXIMUM 5% SLOPE IN DIRECTION OF TRAVEL AND 2% CROSS SLOPE WITH BROOM FINISH TEXTURE TO MATCH EXISTING |
| 32 13 03 | NEW CONCRETE LANDING WITH MAXIMUM 2% SLOPE IN ANY DIRECTION & BROOM FINISH TEXTURE TO MATCH EXISTING |
| 32 90 01 | PROVIDE NEW LANDSCAPE SHRUBS BETWEEN (E) SIDEWALK AND NEW EQUIPMENT PAD TO SCREEN NEW HVAC CONDENSERS. RECONFIGURE (E) IRRIGATION SYSTEM AS REQUIRED TO PROVIDE PROPER COVERAGE. |

WALL TYPES

- 1 2 x 6 WOOD STUDS WITH 5/8" TYPE "X" GYPSUM BOARD E.F.
- 2 2 x 6 WOOD STUDS WITH 5/8" TYPE "X" GYPSUM BOARD @ ROOM INTERIOR
- 3 2 x 6 WOOD STUDS WITH SHEAR PLYWOOD ON ONE FACE, S.S.D.
- 4 2 x 6 WOOD STUDS WITH SHEAR PLYWOOD ON ONE FACE & 5/8" TYPE "X" GYPSUM BOARD E.F.
- 5 2 x 6 WOOD STUDS WITH SHEAR PLYWOOD ON ONE FACE & 5/8" TYPE "X" GYPSUM BOARD @ ROOM INTERIOR
- 6 2 x 4 WOOD STUDS WITH 5/8" TYPE "X" GYPSUM BOARD E.F.
- 7 2 x 4 WOOD STUDS WITH 5/8" TYPE "X" GYPSUM BOARD @ ROOM INTERIOR
- 8 6" METAL STUDS WITH 5/8" TYPE "X" GYPSUM BOARD E.F.
- 9 6" METAL STUDS WITH 5/8" TYPE "X" GYPSUM BOARD @ ROOM INTERIOR
- 10 3-5/8" METAL STUDS WITH 5/8" TYPE "X" GYPSUM BOARD E.F.
- 11 3-5/8" METAL STUDS WITH 5/8" TYPE "X" GYPSUM BOARD @ ROOM INTERIOR
- 12 4" METAL C-H STUDS WITH 1" SHAFT LINER PANELS AND 5/8" TYPE "X" GYPSUM BOARD @ ROOM INTERIOR
- 13 4" METAL STUDS STAGGERED WITHIN 6" TOP AND BOTTOM TRACKS WITH (1) LAYER OF 5/8" TYPE "X" GYPSUM BOARD ON ONE FACE AND (2) LAYERS OF 5/8" TYPE "X" GYPSUM BOARD ON THE OTHER
- 14 7/8" METAL FURRING CHANNELS WITH 5/8" TYPE "X" GYPSUM BOARD @ ROOM INTERIOR

WALL SYMBOL LEGEND

| | |
|--|------------------------------------|
| | EXISTING WALL - TO REMAIN IN PLACE |
| | EXISTING WALL - TO BE DEMOLISHED |
| | NEW WALL - PER WALL TYPES |

RossDrulisCusenbery

18294
Sonoma Highway
Sonoma
CA 95476

TEL 707 996 8448
FAX 707 996 8542

ARCHITECTURE

BALLETTO VINEYARDS & WINERY HOSPITALITY IMPROVEMENTS

5702 OCCIDENTAL RD
SANTA ROSA,
CALIFORNIA 95401

REVISIONS

| No. | Description | Date |
|-----|-------------|------|
| | | |

PERMIT SUBMITTAL

Sheet Title

FIRST LEVEL FLOOR PLAN - NEW HOSPITALITY AREA

Drawn By EW Checked By EW

Scale:
As indicated

Date:
August 10, 2018

Project No. 2018059

A2.10

Drawing No.

If this drawing is not 24" x 36", it is a reduced print - scale accordingly. All rights reserved. Material may not be reproduced in any form without permission from RossDrulisCusenbery Architecture, Inc.